

COPY RIGHT & CONFIDENTIAL  
THIS DOCUMENT IS THE EXCLUSIVE PROPERTY OF BEML & CONTAINS CONFIDENTIAL INFORMATION. THIS DOCUMENT OR ITS CONTENTS SHALL NOT BE USED, REPRODUCED OR DISCLOSED IN WHOLE OR IN PART, WITHOUT PRIOR WRITTEN PERMISSION OF BEML. THIS DOCUMENT & ALL ITS COPIES SHALL BE RETURNED TO BEML ON DEMAND  
DRAWING RELEASED FROM PLM, PHYSICAL SIGNATURE NOT REQUIRED

|  |           |       |        |          |           |          |   |           |            |    |
|--|-----------|-------|--------|----------|-----------|----------|---|-----------|------------|----|
| MACHINING DEVIATIONS<br>FOR LINEAR DIMENSIONS  | RANGE     | 0 - 6 | 6 - 30 | 30 - 120 | 120 - 315 | 315-1000 | 1000-2000                                 | 2000-4000 | ABOVE 4000 | RA |
|  | TOLERANCE | ±0.1  | ±0.2   | ±0.3     | ±0.5      | ±0.8     | ±1.2                                      | ±2        | ±3         | ~  |
| FOR DIMENSIONAL TOLERANCES OF SHEET METAL PARTS AND WELDED STRUCTURES, REFER STD. RD-227 |           |       |        |          |           |          |   |           |            |    |
| UNSPECIFIED TOLERANCE FOR LINEAR AND ANGULAR DIMENSIONS REF. IS 2102 (PT-1) (MEDIUM)     |           |       |        |          |           |          | QUALITY OF WELD JOINTS REF, RD 230 MEDIUM |           |            |    |
| VALUES OF SURFACE TEXTURE SHALL BE AS PER COMPANY STD DS. 1012.C.                        |           |       |        |          |           | STATUS:  | PROTO                                     |           |            |    |
| WELDING SHALL BE CARRIED OUT AS PER IS: 9595-96  |           |       |        |          |           |          |   |           |            |    |
|  |           |       |        |          |           |          |   |           |            |    |

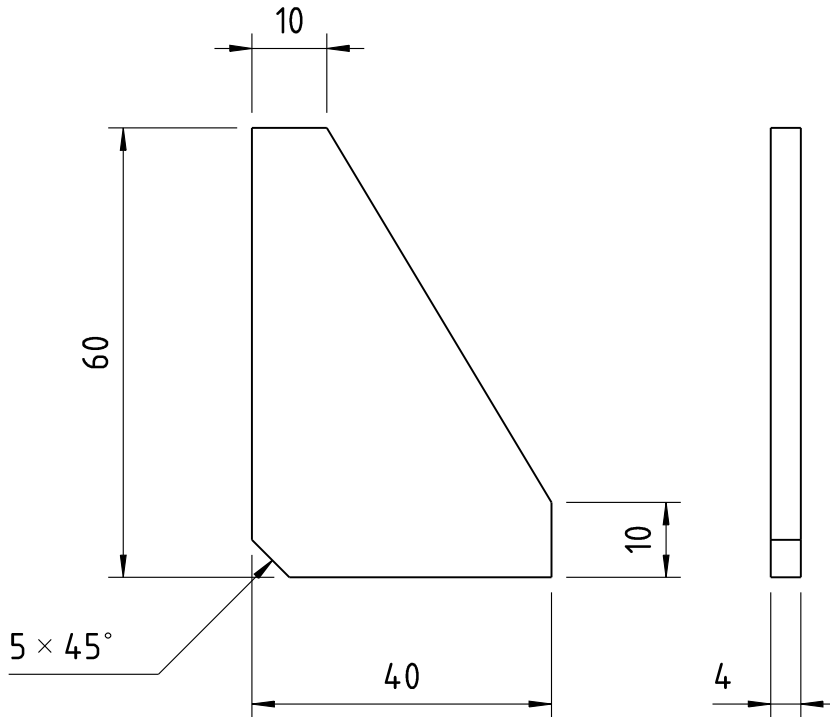

UNCONTROLLED

NOTE:-

1. REMOVE SHARP EDGES AND BURRS.

|                   |       |        |         |                |     |                  |      |             |                |                           |           |     |     |              |                  |          |  |
|-------------------|-------|--------|---------|----------------|-----|------------------|------|-------------|----------------|---------------------------|-----------|-----|-----|--------------|------------------|----------|--|
| N6                | 0.8   |        |         | R136593025     |     |                  |      | 60X40X4 THK |                |                           |           |     |     |              |                  |          |  |
| N7                | 1.6   |        |         | SL.No.         | QTY | PART / STOCK No. |      |             |                | DESCRIPTION               |           |     |     | SIZE         | COMPANY STD./I.S | Wt. (Kg) |  |
| N8                | 3.2   |        |         |                |     |                  |      |             |                | MATERIAL                  |           |     |     |              |                  |          |  |
| N9                | 6.3   |        |         |                |     |                  |      |             | PRODUCT        | MUMBAI METRO CARS L2 & L7 |           |     |     |              |                  |          |  |
| N10               | 12.5  |        |         |                |     |                  |      |             | REF DRG        |                           |           |     |     |              |                  |          |  |
| N11               | 25    |        |         |                |     |                  |      |             | MATERIAL       | SUS301 LLT                |           |     |     |              |                  |          |  |
| N12               | 50    |        |         |                |     |                  |      |             | HEAT TREAT.    |                           | APPD      | MS  |     |              |                  |          |  |
|                   |       |        |         |                |     |                  |      |             | SURFACE TREAT. |                           | REVD      | SSB |     |              |                  |          |  |
|                   |       |        |         |                |     |                  |      |             | TITLE          | GUSSET                    |           |     |     | CHKD         | VSE              |          |  |
|                   |       |        |         |                |     |                  |      |             | DRWN           |                           |           |     |     | MM           |                  |          |  |
|                   |       |        |         |                |     |                  |      |             | SCALE          |                           |           |     |     |              | SHEET            | Wt.      |  |
|                   |       |        |         |                |     |                  |      |             | 1:1            |                           |           |     |     |              | 1 OF 1           | 0.05Kg   |  |
| GRADE No.         | VALUE | SYMBOL |         |                |     |                  |      |             | DRG No.        |                           |           |     | ALT |              |                  |          |  |
| SURFACE ROUGHNESS |       |        | ALT.NO. | ECN NO/CHANGES |     |                  | DATE | BY          | CHKD           | APPD                      | 525-56262 |     |     |              |                  |          |  |
|                   |       |        |         |                |     |                  |      |             |                |                           |           |     |     | BEML LIMITED |                  |          |  |
|                   |       |        |         |                |     |                  |      |             |                | NEW FRONTIERS. NEW DREAMS |           |     |     |              |                  |          |  |